

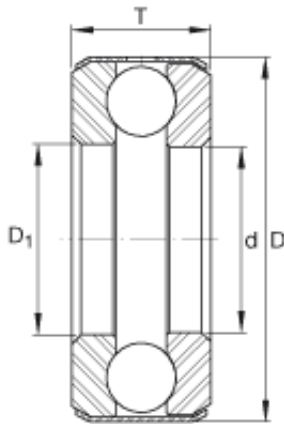

# SNR Bearing Argentina



## INA D3 thrust ball bearings

Bearing No. D3

|                      |  |
|----------------------|--|
| Size                 | 15.875x34.138x14.3 mm                  |
| Bore Diameter        | 15,875 mm                              |
| Outer Diameter       | 34,138 mm                              |
| Width                | 14,3 mm                                |
| d                    | 5/8 inch                               |
| d                    | 15,875 mm                              |
| D                    | 1,344 inch                             |
| D                    | 34,138 mm                              |
| T                    | 0,563 inch                             |
| T                    | 14,3 mm                                |
| D <sub>1</sub>       | 0,656 inch                             |
| m                    | 0,14 lbs / Weight                      |
| m                    | 63 g / Weight                          |
| C <sub>a</sub>       | 4100 lbf / Dynamic load rating (axial) |
| C <sub>a</sub>       | 18200 N / Dynamic load rating (axial)  |
| C <sub>0a</sub>      | 6700 lbf / Static load rating (axial)  |
| C <sub>0a</sub>      | 29800 N / Static load rating (axial)   |
| Category             | Thrust Ball Bearing                    |
| Inventory            | 7.0                                    |
| Manufacturer Name    | SCHAEFFLER GROUP                       |
| Minimum Buy Quantity | N/A                                    |
| Weight / Kilogram    | 0                                      |
| EAN                  | 4012802146844                          |
|                      |  |

D3 Bearing 2D drawings and 3D CAD models



## SNR Bearing Argentina

|                                     |  |
|-------------------------------------|--|
| Product Group                       | B04270   |
| Rolling Element                     | Ball Bearing   |
| Thrust Bearing                      | Yes  |
| Single or Double Direction          | Single Direction   |
| Banded                              | Yes  |
| Cage Material                       | Steel  |
| Precision Class                     | ABEC 1   ISO P0  |
| Component Description               | Roller Assembly Plus Raceways  |
| Other Features                      | Single Row   |
| Long Description                    | 5/8" Bore 1; 21/32" Bore 2; 1-11/32" Outside Diameter; 9/16" Height; Ball Bearing; Single Direction; Banded; Steel Cage; ABEC 1   ISO P0 Precision |
| Inch - Metric                       | Inch   |
| Category                            | Thrust Ball Bearings   |
| UNSPSC                              | 31171552   |
| Harmonized Tariff Code              | 8482.10.50.08  |
| Noun                                | Bearing  |
| Keyword String                      | Ball Thrust  |
| Manufacturer URL                    | <a href="http://www.ina.com">http://www.ina.com</a>  |
| Weight / LBS                        | 0.138  |
| Outside Diameter                    | 1.344 Inch   34.138 Millimeter   |
| Height                              | 0.563 Inch   14.3 Millimeter   |
| Bore 2                              | 0.656 Inch   16.662 Millimeter   |
| Overall Height with Aligning Washer | 0 Inch   0 Millimeter  |
| Bore 1                              | 0.625 Inch   15.875 Millimeter   |