

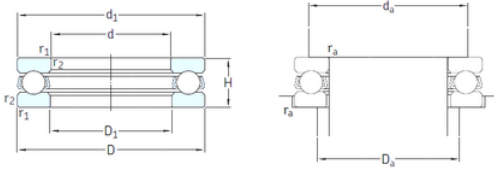

# SNR Bearing Argentina



## SKF 51218 thrust ball bearings

Bearing No. 51218

Size	90x135x35 mm
Bore Diameter	90 mm
Outer Diameter	135 mm
Width	35 mm
d	90 mm
D	135 mm
H	35 mm
d1	135 mm
r1 min.	1,1 mm
r2 min.	1,1 mm
D1	93 mm
da min.	117 mm
Da max.	108 mm
ra max.	1 mm
Weight	1,7 Kg
Basic dynamic load rating (C)	112 kN
Basic static load rating (C0)	290 kN
Fatigue load limit (Pu)	10,4
Reference speed	2000 r/min
Limiting speed	2800 r/min
Category	Thrust Ball Bearing
Inventory	0.0
Manufacturer Name	SKF
Minimum Buy Quantity	N/A
Weight / Kilogram	1.68
EAN	7316577006820

51218 Bearing 2D drawings and 3D CAD models



## SNR Bearing Argentina

Product Group	B00308
Rolling Element	Ball Bearing
Thrust Bearing	Yes
Single or Double Direction	Single Direction
Banded	No
Cage Material	Steel
Precision Class	ABEC 1   ISO P0
Component Description	Roller Assembly Plus Raceways
Other Features	Single Row
Long Description	90MM Bore 1; 93MM Bore 2; 135MM Outside Diameter; 35MM Height; Ball Bearing; Single Direction; Not Banded; Steel Cage; ABEC 1   ISO P0 Precision
Inch - Metric	Metric
Category	Thrust Ball Bearings
UNSPSC	31171507
Harmonized Tariff Code	8482.10.50.08
Noun	Bearing
Keyword String	Ball Thrust
Manufacturer URL	<a href="http://www.skf.com">http://www.skf.com</a>
Manufacturer Item Number	51218
Weight / LBS	3.709
Outside Diameter	5.315 Inch   135 Millimeter
Overall Height with Aligning Washer	0 Inch   0 Millimeter
Bore 2	3.661 Inch   93 Millimeter
Height	1.378 Inch   35 Millimeter
Bore 1	3.543 Inch   90 Millimeter
bore diameter:	90 mm
static load capacity:	290 kN



## SNR Bearing Argentina

outside diameter:	135 mm
dynamic load capacity:	112 kN
overall width:	35 mm
maximum rpm:	2800 RPM
thrust bearing type:	Single-Direction
cage material:	Steel
outside diameter design:	Straight
fillet radius:	1 mm
separable or banded:	Separable
series:	512
precision rating:	ABEC 1 (ISO Class Normal)
$d_1$	135 mm
$D_1$	93 mm
$r_{1,2}$ min.	1.1 mm
$d_a$ min.	117 mm
$D_a$ max.	108 mm
$r_a$ max.	1 mm
Basic dynamic load rating C	112 kN
Basic static load rating $C_0$	290 kN
Fatigue load limit $P_u$	10.4 kN
Minimum load factor A	0.55
Mass bearing (including seat washer where applicable)	1.7 kg