

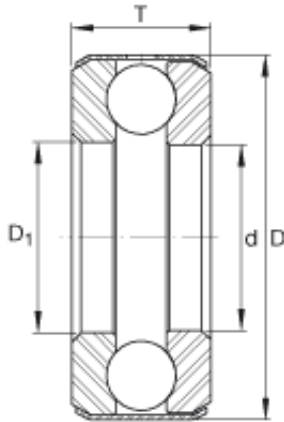

SNR Bearing Argentina



INA D22 thrust ball bearings

Bearing No. D22

D22 Bearing 2D drawings and 3D CAD models

Size	46.038x78.588x20.65 mm
Bore Diameter	46,038 mm
Outer Diameter	78,588 mm
Width	20,65 mm
d	1 13/16 inch
d	46,038 mm
D	3,094 inch
D	78,588 mm
T	0,813 inch
T	20,65 mm
D ₁	1,844 inch
m	0,86 lbs / Weight
m	388 g / Weight
C _a	10600 lbf / Dynamic load rating (axial)
C _a	47000 N / Dynamic load rating (axial)
C _{0a}	26500 lbf / Static load rating (axial)
C _{0a}	118000 N / Static load rating (axial)
Category	Thrust Ball Bearing
Inventory	0.0
Manufacturer Name	SCHAEFFLER GROUP
Minimum Buy Quantity	N/A
Weight / Kilogram	0.465
Product Group	B00308



SNR Bearing Argentina

Rolling Element	Ball Bearing
Thrust Bearing	Yes
Single or Double Direction	Single Direction
Banded	Yes
Cage Material	Steel
Precision Class	ABEC 1 ISO P0
Component Description	Roller Assembly Plus Raceways
Other Features	Single Row
Long Description	1-13/16" Bore 1; 1-27/32" Bore 2; 3-3/32" Outside Diameter; 13/16" Height; Ball Bearing; Single Direction; Banded; Steel Cage; ABEC 1 ISO P0 Precision
Inch - Metric	Inch
Category	Thrust Ball Bearings
UNSPSC	31171552
Harmonized Tariff Code	8482.10.50.08
Noun	Bearing
Keyword String	Ball Thrust
Manufacturer URL	http://www.ina.com
Weight / LBS	0.862
Bore 1	1.813 Inch 46.05 Millimeter
Overall Height with Aligning Washer	0 Inch 0 Millimeter
Bore 2	1.844 Inch 46.838 Millimeter
Height	0.813 Inch 20.65 Millimeter
Outside Diameter	3.094 Inch 78.588 Millimeter