

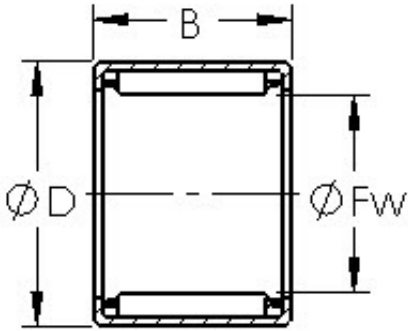

# SNR Bearing Argentina



## AST SCE910 needle roller bearings

Bearing No. SCE910

Bore Diameter	14,3 mm
Outer Diameter	19,05 mm
Width	15,875 mm
Bearing Type	Cage Retained Rollers
Outer Dia (D)	0.7500
Width (B)	0.6250
Dynamic Load Rating (Cr)	2,120
Static Load Rating (Cor)	3,150
Max Speed (Grease) (X1000 RPM)	19,600
Shaft (Fw)	0.563
Weight (g)	10.00
Material - Drawn cup: Hardened carbon steel alloy, Rollers	52100 Chrome steel or equivalent

SCE910 Bearing 2D drawings and 3D CAD models