

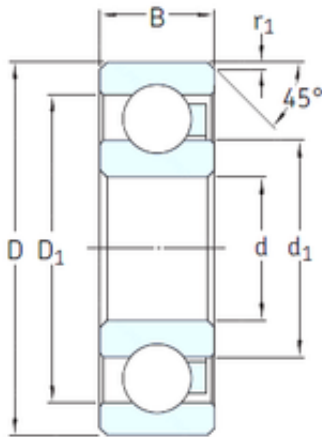

## SNR Bearing Argentina



40 mm x 68 mm x 9 mm SKF 16008/HR22T2  
deep groove ball bearings

Bearing No. 16008/HR22T2

Size	40x68x9 mm
Bore Diameter	40 mm
Outer Diameter	68 mm
Width	9 mm
d	40 mm
D	68 mm
B	9 mm
C	9 mm
d1	49,4 mm
r1 min.	0,4 mm
D1	58,6 mm
Weight	0,0305 Kg
Basic dynamic load rating (C)	0,315 kN
Basic static load rating (C0)	0,24 kN

16008/HR22T2 Bearing 2D drawings and 3D CAD models